

Installation plan

- 1) Walls 10ft high min, painted white.
- 2) floor painted mid grey
- 3) Very low overhead lights (spots)

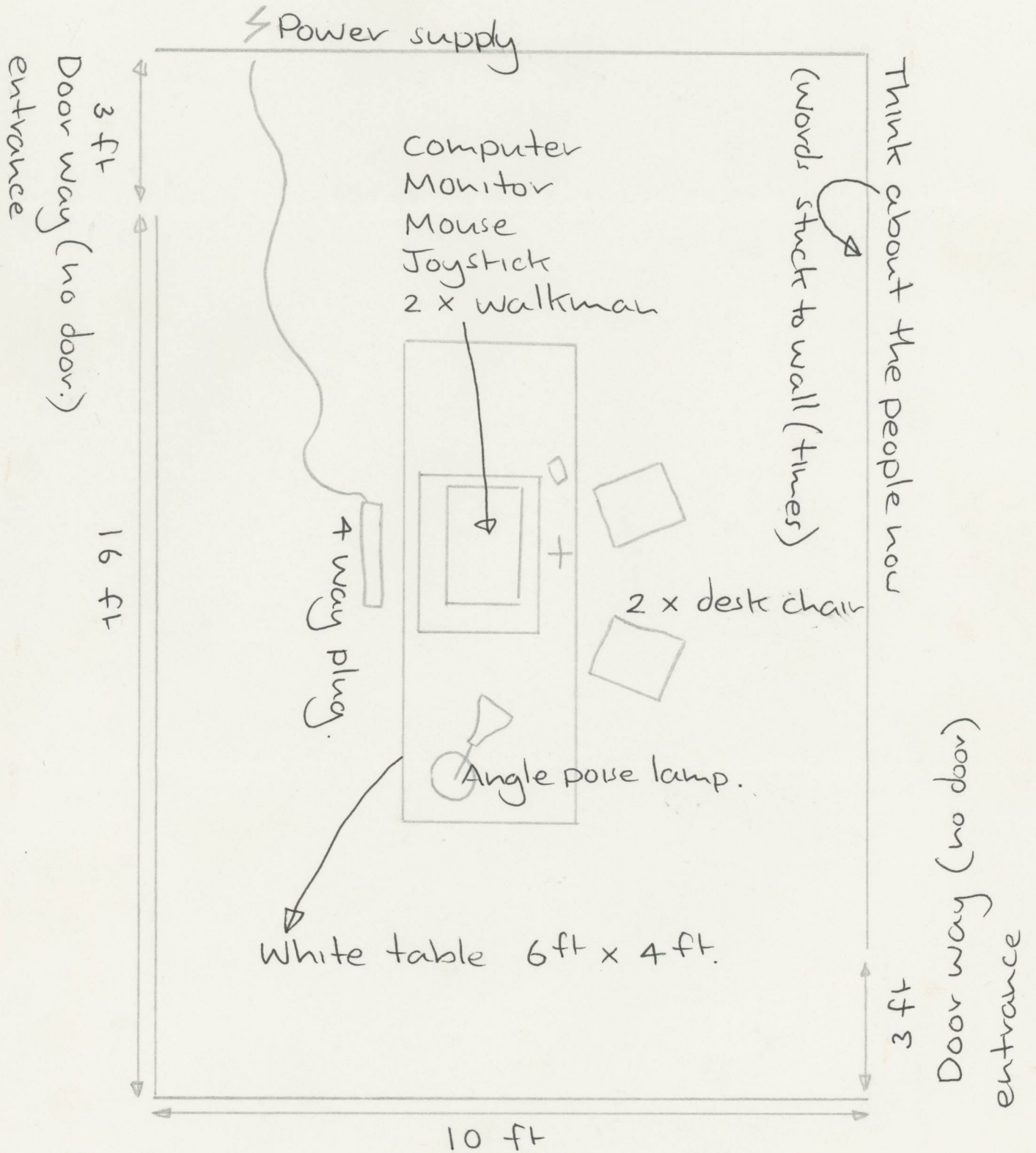

Equipment list

- 1 x Amiga 2000 computer
- 1 x 40MB hard disk with 20 MB of RAM
- 1 x Amiga colour monitor, stereo.
- 1 x Mouse. (sermon)
- 1 x Joystick (sermon)
- 2 x Sony Walkman (standard)
- 1 x Angle lamp.
- 1 x 4 way plug.
- 2 x desk chair. (computer desk types with wheels)
- 1 x White table 6ft x 4ft
- 2 x Audio to phono lead. (sermon)
- 'Think about the people now' letters (sermon)
- 1 x can of spray mount.
- Programme software (sermon)
- Hard disk software (system disk)
- 2 x 6 min endless audio tapes. (sermon)
- 12 x Walkman Batteries.
- Avaldite glue (sermon)

The equipment with : (sermon) next to it indicates that I shall bring this with me.

Setting up installation

The installation will take about five hours to set up. This includes installing software and mounting letters to wall.

I can start work on the installation when I arrive on Monday 9 Sept. It would help if the space is prepared before I arrive.